



ASTON FITTINGS & FLANGES MANUFACTURING LTD.



Cert. No. LRQ 0961092

Tel: ++44 (0)121-778 6001
 Fax: ++44 (0)121-778 6002
 sales@astonfittings.com

Air Distribution Manifold – 6 Way

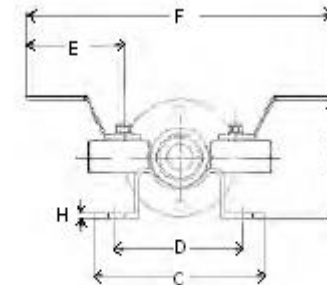
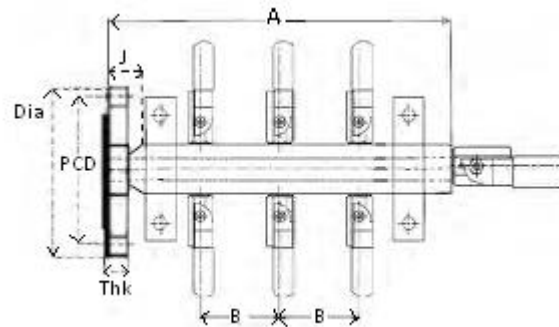

Note: supplied with mounting legs as standard

Aston Part No	Inlet/Outlet	No. of takeoffs	A	B	C	D	E	F	G	H
ADM6W-316-16-150	1" 150lb Flanged Inlet / 1/2" Outlet c/w ball valve	6 x Drains, all c/w 1/2" ball valves	416 ± 10mm	100	125	100	95	355	118	4/5

1" ANSI 150lb Flange	Dia.	PCD	Thk	J
	107.9	79.4	17.5	93-94

Manifolds manufactured from:	OD	WT
2" Sch 80 Pipe	60.3	7.5

Dimensions in mm unless otherwise stated.

We reserve the right to change tolerances and dimensions without prior notice.

Units 1-3 Eagle Works 2 Springcroft Road Tyseley Birmingham B11 3EL England

Visit our web page at: <http://www.astonfittings.com>

VALVES -FITTINGS -FLANGES

TUBE -INSTRUMENTATION PACKAGES -SUB CONTRACT MACHINING

Registered in England No 2913370



ASTON FITTINGS & FLANGES MANUFACTURING LTD.



Cert. No. LRQ 0961092

Tel: ++44 (0)121-778 6001
 Fax: ++44 (0)121-778 6002
 sales@astonfittings.com

Air Distribution Manifold – 10 Way

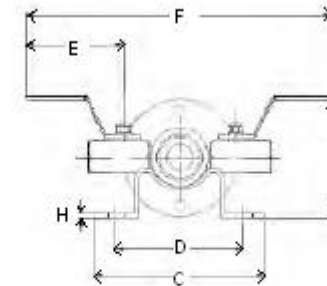
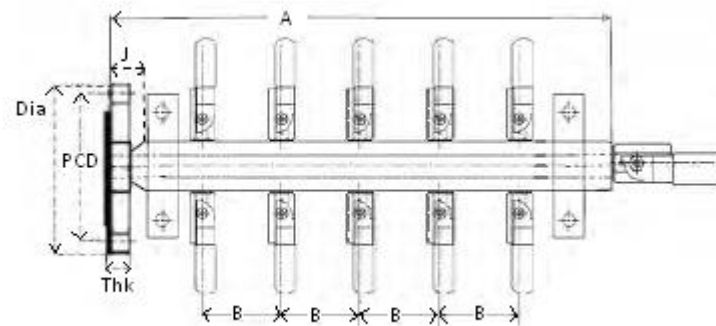

Note: supplied with mounting legs as standard

Aston Part No	Inlet/Outlet	No. of takeoffs	A	B	C	D	E	F	G	H
ADM10W-316-16-150	1" 150lb Flanged Inlet / 1/2" Outlet c/w ball valve	10 x Drains, all c/w 1/2" ball valves	616 ± 10mm	100	125	100	95	355	118	4/5

1" ANSI 150lb Flange	Dia.	PCD	Thk	J
	107.9	79.4	17.5	93-94

Manifolds manufactured from: 2" Sch 80 Pipe	OD	WT
	60.3	7.5

Dimensions in mm unless otherwise stated.

We reserve the right to change tolerances and dimensions without prior notice.

Units 1-3 Eagle Works 2 Springcroft Road Tyseley Birmingham B11 3EL England

Visit our web page at: <http://www.astonfittings.com>

VALVES -FITTINGS -FLANGES

TUBE -INSTRUMENTATION PACKAGES -SUB CONTRACT MACHINING

Registered in England No 2913370